

Installation guide

Solenoid valve

Type EV227B

032R9277

032R9277

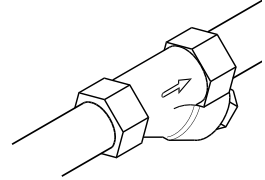
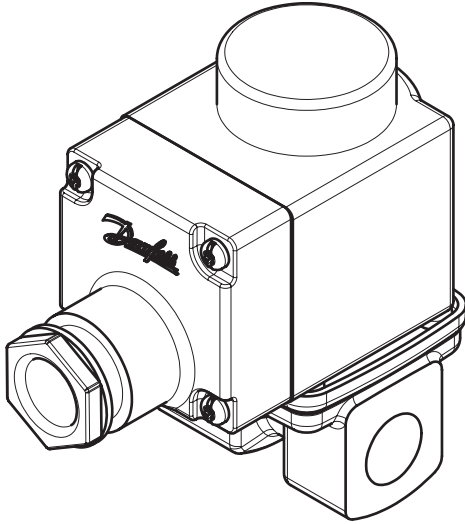

≥ 297 Microns

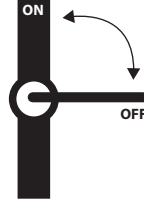

1

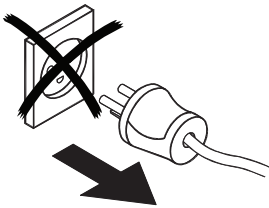

2

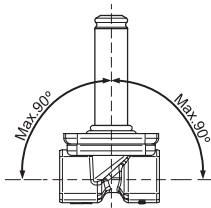

3

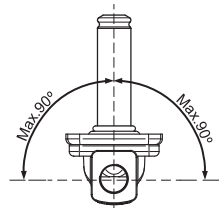

4

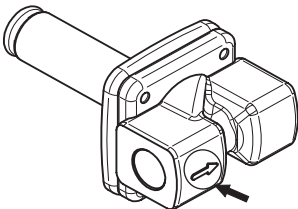

5

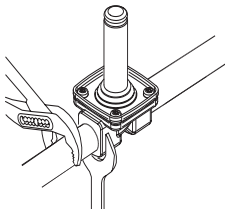

6

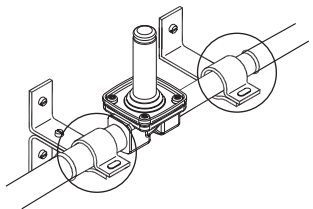

7

8

9

10

11

12

13

DN	Max. Working Pressure (MWP)	Max. Test pressure (PT)
	[bar]	[bar]
10 - 22	10	16
EN 60730-2-8		

Visit www.products.danfoss.com for further technical data.
 Para más información, visite www.products.danfoss.es
 Rendez-vous sur le site www.products.danfoss.fr pour plus de données techniques.